

DRIMASTER ANTI-CONDENSATION UNIT

Condensation dampness is more common than you think, particularly in older homes. As winter sets in and the temperature starts to drop many of us will notice the problem more.



PIV How does it work?

CREATES A HEALTHY LIVING ENVIRONMENT

Significantly improves indoor air quality by removing indoor air pollutants such as carbon monoxide and keeping out external pollutants such as traffic fumes and pollen.

MOISTURE AND CONDENSATION ARE DRIVEN OUT

The filtered air gently pressurises the home from inside out, forcing out the stale air.

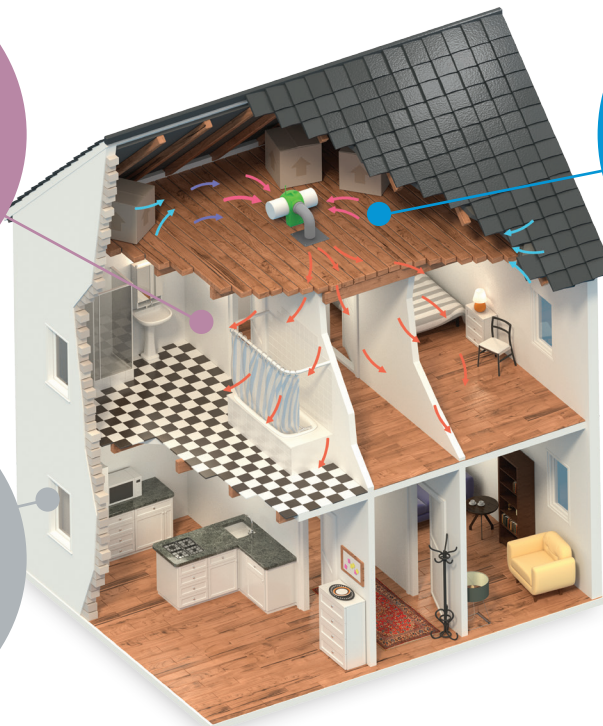

NO NEED TO OPEN WINDOWS TO VENTILATE

Clean, fresh air is continuously drawn in through the lofts natural leakage points, passed through the filters and fed into the property via a central hallway diffuser.

The Drimaster Anti-Condensation Unit offers a ventilation solution for the whole property, using the tried and tested Positive Input Ventilation (PIV) principle, where a small amount of fresh, filtered air is introduced into the home at a continuous rate, encouraging movement of air from inside to outside. This process prevents condensation and removes allergens such as dust mites and the pollutants caused by cooking and cleaning from the air. The results are a fresh and healthy indoor environment in which condensation and mould cannot exist, and where indoor pollutants including harmful Radon gas are kept to a minimum - all great news for allergy sufferers.

- **Prevents condensation dampness.** Drimaster reduces the humidity levels in the air, preventing condensation mould growth and controlling dust-mite allergens.
- **Improves indoor air quality.** Indoor pollutants from cooking and cleaning are removed, while outdoor pollutants including pollen and radon gas are kept out.
- **Health benefits.** Clinically proven to help allergy and asthma sufferers.
- **Extremely low power consumption.** Costs around 1p per day to run.
- **Easy installation and very low maintenance.** Filter clean or replacement every five years.
- **5 Year Warranty.** For peace of mind.

Follow the installation and maintenance document supplied with the unit, paying particular attention to:

- 1.1. Loft ventilation; whilst the system is fully automatic its obviously drawing air from the loft and this air has to be replaced.
 - 1.1.1. A loft sealed from the outside will have a detrimental effect on the DRIMASTER's efficiency.
 - 1.1.2. A loft floor or room ceilings below which contain unsealed holes or recessed lighting such as spotlights can allow the air to be drawn from the dwelling and hence re circulate it. Also ensure the loft hatch is sealed airtight.
- 1.2. The position of the unit's supply air diffuser in the landing ceiling should be carefully considered.
 - 1.2.1. Be aware of the possibility of asbestos in the ceilings and the regulations requiring a test before you cut the hole.
 - 1.2.2. Site the diffuser so that the airflow from it will be of least annoyance to the householder. **Note: The positioning of the diffuser should be in strict accordance with the table shown below to ensure correct operation:-**

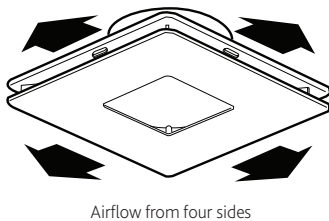

| Speed Setting | Minimum distance of diffuser from wall |
|---------------|--|
| 1 | 100mm |
| 2 | 155mm |
| 3 | 400mm |
| 4 | 625mm |
| 5 | 850mm |
| 6 | 1000mm |

- 1.2.3. Site the diffuser so that nothing i.e. smoke alarms are within 1 Metre of it, and that the air doesn't discharge directly to a wall.
- 1.2.4. Normally the diffuser discharges air from all four sides but is supplied with foam strips to blank any side with the potential for nuisance. (see fig. above right).

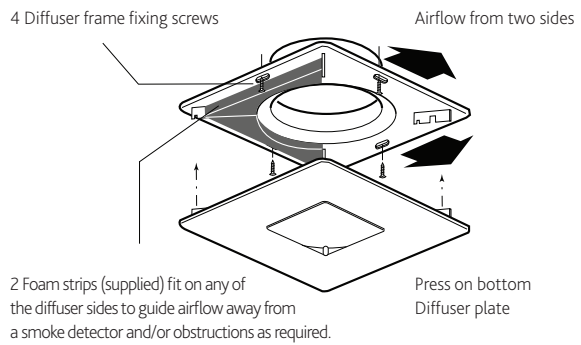

- 1.3. The position of the unit.
 - 1.3.1. Units can be installed suspended from the roof joist or mounted on the ceiling joist.

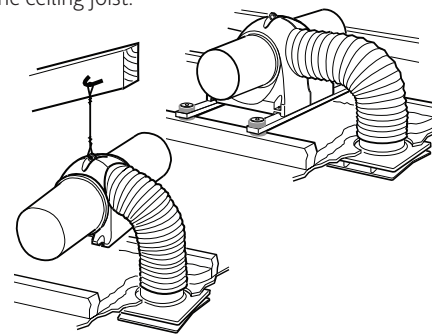

- 1.3.2. Although the unit is exceptionally quiet try to keep it away from 'over bed' positions.
- 1.3.3. The unit is supplied with a pre wired mains to low voltage power supply and a mains fused spur box, as the unit is to be on at all times for effective ventilation ensure the power supply cannot be manually disrupted.
- 1.4. Setting to work.
 - 1.4.1. Set the DRIMASTER speed appropriate to the size and type of property, as detailed in the installation guide supplied with the unit.

2.0 On maintenance

None required in the first five years.

3.0 On spares

The only replaceable items on a DRIMASTER are the filters and they only after five years, should a control or motor defect arise then complete unit replacement is recommended.

Note: If you have a wet room which is not situated off the main hallway, ie an en suite, you may need additional ventilation for these, such as a [Nuair dMEV](#) decentralised extract fan.

| FOR HOMES WITH LOFTS | | | FOR HOMES WITH NO LOFT | |
|--|--|---|---|---|
| | | | | |
| Drimaster | Drimaster Heat | Drimaster 2000 | Flatmaster | Flatmaster 2000 |
| The Drimaster provides whole house ventilation for two and three storey homes. | The Drimaster Heat comes with all the functionality of our Drimaster however has an integral heater to provide heating on cooler days. | The Drimaster 2000 comes with an intelligent sensor that will measure when the temperature in the loft is higher than in your home. The system will then boost to provide your home with the heat gained from the loft. | Specifically designed for homes without lofts but can be used to ventilate basements and cellars. | The Flatmaster 2000 comes with all the functionality of our Flatmaster but with an integral heater to provide heating on cooler days. |