

# XBC75-V

## Revit Model Features

These models use type catalogues so all variants of the XBC75-V range, when utilising the same heating coil option, can be inserted using the same .rfa file.  
See the Read Me file attached for further info.

**XBC75-V-L.rfa** holds all the **L**PHW heater versions on the unit e.g. XBC75-V-LCO.

**XBC75-V-E.rfa** holds all the **e**lectric heater versions on the unit e.g. XBC75-V-EAT-R.

**XBC75-V-N.rfa** holds all the **n**o heater versions on the unit e.g. XBC75-V-NESWP.

The xbc75-v.rfa model attached includes the following options in the Model Properties Category in the Properties Window

Model Properties	
Show Access Clearance	<input checked="" type="checkbox"/>
Room Side Silencers	<input checked="" type="checkbox"/>
Atmosphere Side Silencers	<input checked="" type="checkbox"/>

1. 'Show Access Clearance' allows you to show or hide the access clearance transparent area of the model

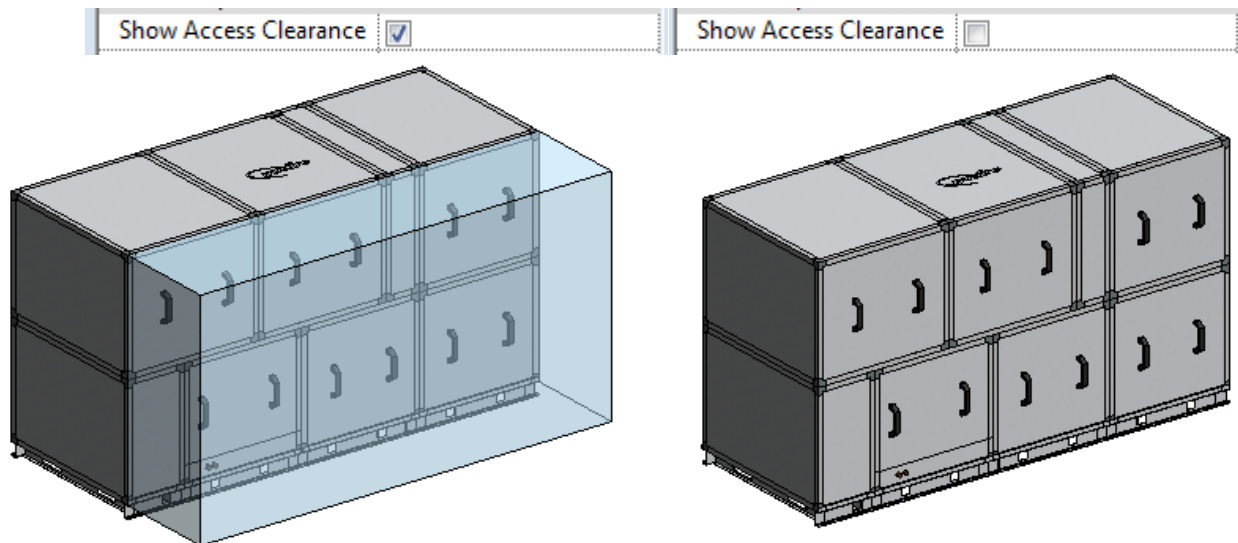

2. You can also choose to show silencers using the tick boxes below.

Room Side Silencer	<input checked="" type="checkbox"/>
Atmosphere Side Silencer	<input checked="" type="checkbox"/>

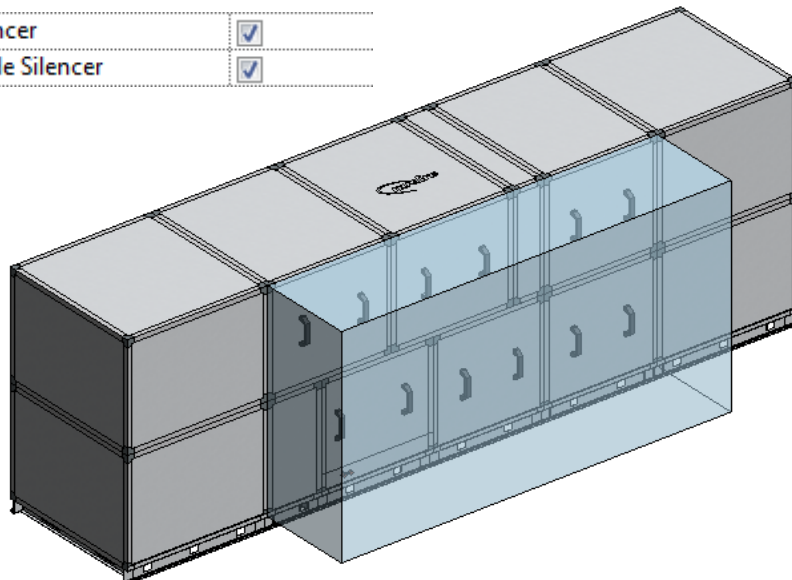

3. If the model is inserted into the project without using the correct procedure then you will be alerted via a red box and '**DO NOT USE**' wording around the model. The model code will also show this same message in the schedules. Please then refer to the additional 'Please read Me File' packaged with this family for the correct insertion procedure.

