

Boxer Supply AHU - Size 3 **Revit Model Features**

1. The model uses a type catalogue so all standard variants of the size 3 Boxer supply AHU can be inserted using the same .rfa file (see Read Me file attached for further info)

The ESBHS3.rfa model attached includes the following options in the Model Properties Category in the Properties Window

Model Properties	
Show Room Side Silencer	<input type="checkbox"/>
Show Atmosphere Side Silencer	<input type="checkbox"/>
Roof	<input type="checkbox"/>
Show Access Clearance	<input checked="" type="checkbox"/>

2. 'Show Room Side Silencer' and 'Show Atmosphere Side Silencer' allow you to show or hide the matched attenuator we offer (ESBSIL3) for the appropriate side of the AHU.

Show Room Side Silencer	<input type="checkbox"/>
Show Atmosphere Side Silencer	<input type="checkbox"/>

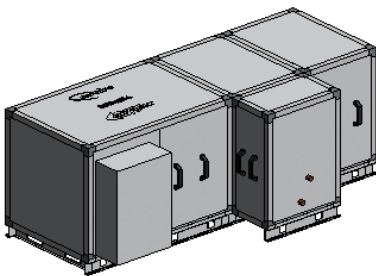

Show Room Side Silencer	<input checked="" type="checkbox"/>
Show Atmosphere Side Silencer	<input type="checkbox"/>

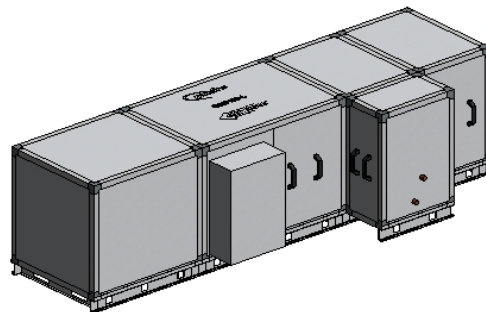

Show Room Side Silencer	<input checked="" type="checkbox"/>
Show Atmosphere Side Silencer	<input checked="" type="checkbox"/>

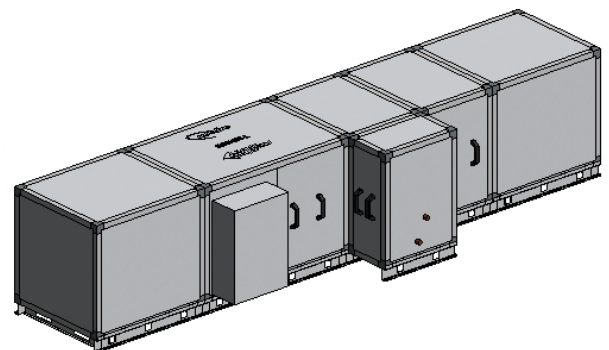

3. 'Roof' allows you to show or hide the weatherproof cover and control box surround if required (or if offered as part of the selection).

Roof	<input type="checkbox"/>
------	--------------------------

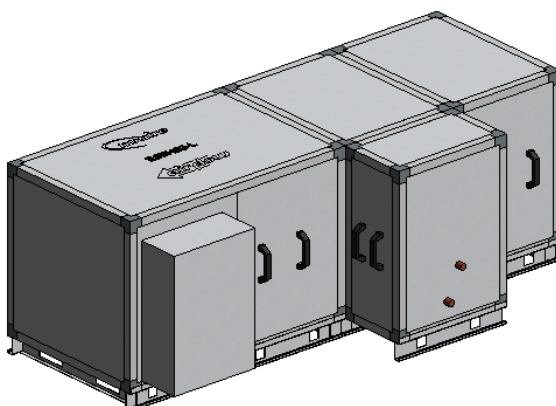

Roof	<input checked="" type="checkbox"/>
------	-------------------------------------

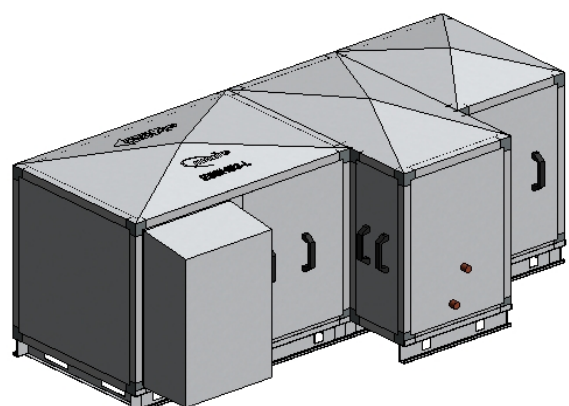

Continued...

4. 'Show Access Clearance' allows you to show or hide the access clearance transparent area of the model.

Note: If the access clearance area is hidden it will still affect the collision detection analysis.

